

Ora Bolt Through Fixing

Installation Guide

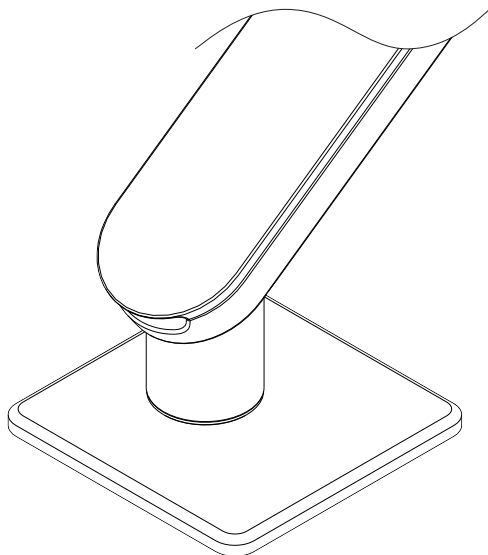

COMPONENT CHECKLIST

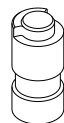

Arm Spigot (x1)

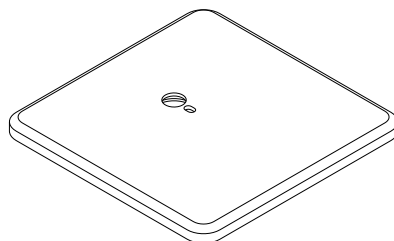

Clamp Plate (x1)

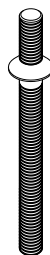

M8 Stud Bolt (x1)

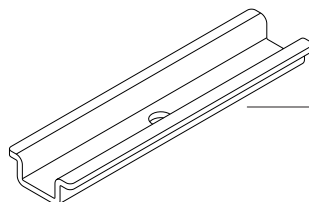

Clamp Bar (x1)



M8 Flange Nut (x1)

CAPACITY

Weight: 2 - 8kg (4.4 - 17.6lb)
Display Size: Up to 35" (curved or flat)
(Larger monitors within the weight capacity may be compatible, please contact Atdec for advice).

WARRANTY

10 Years Limited

TOOLS REQUIRED

4mm Hex Key (supplied with Ora arm)
8.5mm (or 11/32") drill bit
Power Drill
13mm Spanner
Phillips head screwdriver

IMPORTANT INFORMATION

- Install Ora Accessories as per these installation instructions.
- The manufacturer accepts no responsibility for incorrect installation.
- The product is compatible with grommet hole sizes up to 80mm (3.15")
- The product is compatible with desk thicknesses from 0-55mm (0-2.2").
- Do not over-tighten screws and adjustment points on product.
- This product is not suitable for outdoor use.
- Do not use this product for mobile applications.
- Please ensure desk structure and mounting surface are of sufficient strength to support this product and mounted equipment.

ATDEC

No portion of this document or any artwork contained herein should be reproduced in any way without the express written consent of Atdec Pty Ltd. Due to continuing product development, the manufacturer reserves the right to alter specifications without notice. ©20231006

1 For bolt through installations, drill hole in the work surface

1.1

Mark out hole position on the work surface. Use Clamp Plate as a template.

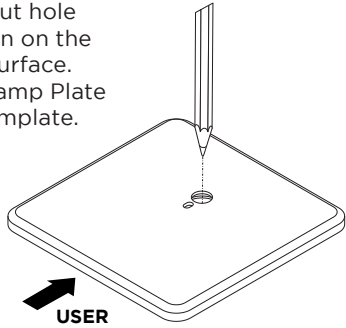

1.2

Drill the hole using a suitable drill bit. Ensure the hole is drilled perpendicular to the work surface and the edges of the clamp are positioned fully on the desk.

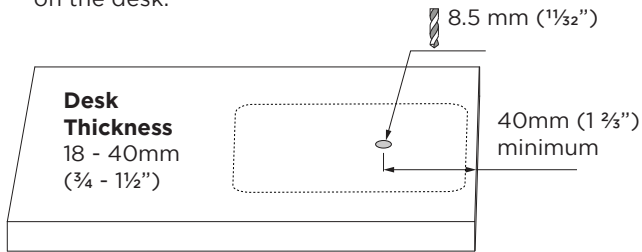

TIP

When positioning the desk clamp, offset the clamp to the left or right of the seating position. The monitor will then be centred for the user.

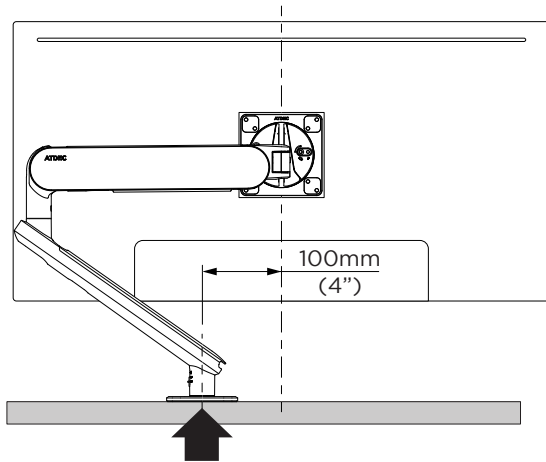

2 Attach Arm Spigot to Clamp Plate

HINT!

Hold Arm Spigot and Clamp Plate together, locating the dimple in the slot, before hand tightening the screw into the spigot.

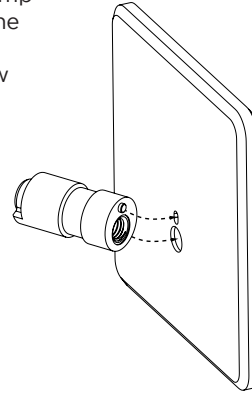

2.1

Screw M8 Stud Bolt through Clamp Plate into Arm Spigot.

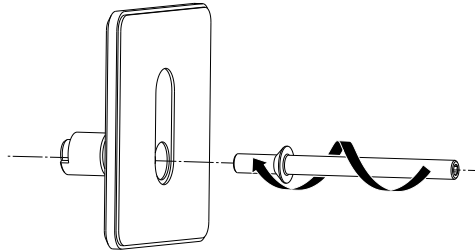

2.2

Tighten firmly with 4mm Hex Key supplied with Arm.

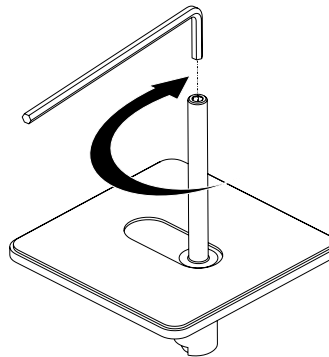

3 Attach plate assembly to desk

Place Clamp Bar over M8 Stud Bolt under the desk as illustrated and secure Flange Nut with spanner.

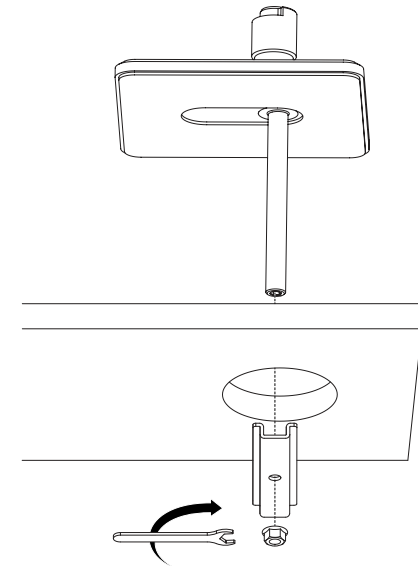

TIP

Support plate while tightening to maintain the correct orientation on the work surface.

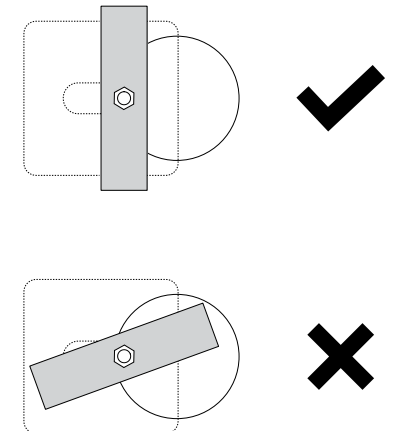

CONTINUE ORA MONITOR ARM ASSEMBLY

Ora monitor arms sold separately. If chosen arm has a supplied desk clamp, retain for future use.

COMPONENT CHECKLIST

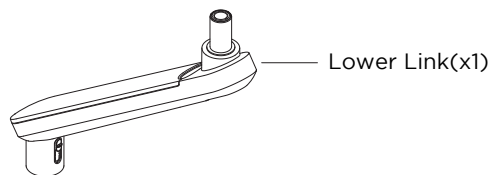
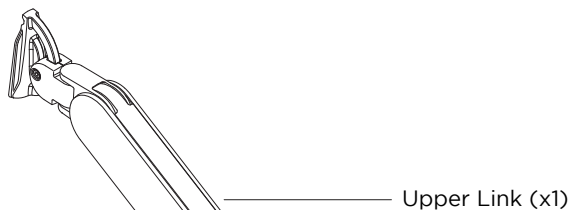

Hardware & Tools



M4x10
Screw
(x4)



Security
Screw
(x1)

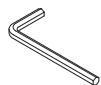

4mm
Hex Key
(x1)

IMPORTANT INFORMATION

- Install Ora Monitor Arm as per these installation instructions.
- The manufacturer accepts no responsibility for incorrect installation.
- Do not over-tighten screws and adjustment points on product.
- This product is not suitable for outdoor use.
- Do not use this product for mobile applications.
- Deep devices (such as all-in-one PCs), VESA mounted accessories (such as mini PC brackets and mounts), and offset VESA locations exert additional leverage that can exceed the capacity of the mount even though the monitor weight may be within the stated range. Please contact Atdec if you would like further information.
- Suits displays with VESA mounting hole patterns 75x75 and 100x100. Spacer kit (sold separately) may be required for recessed 75x75 hole patterns.
- Periodic adjustment to counterbalance and tilt tension may be required.

3 Attach Lower Link to Clamp

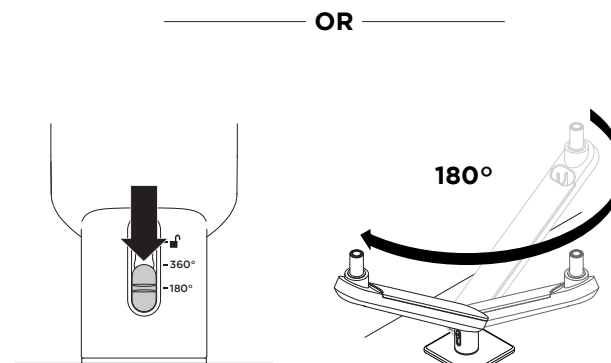
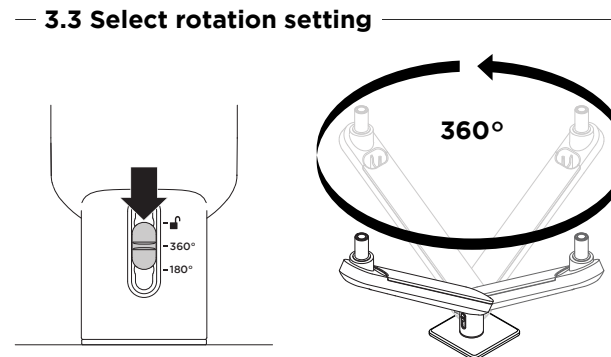
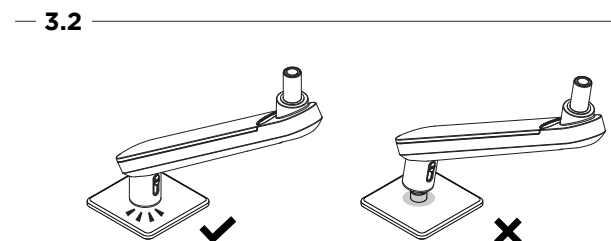
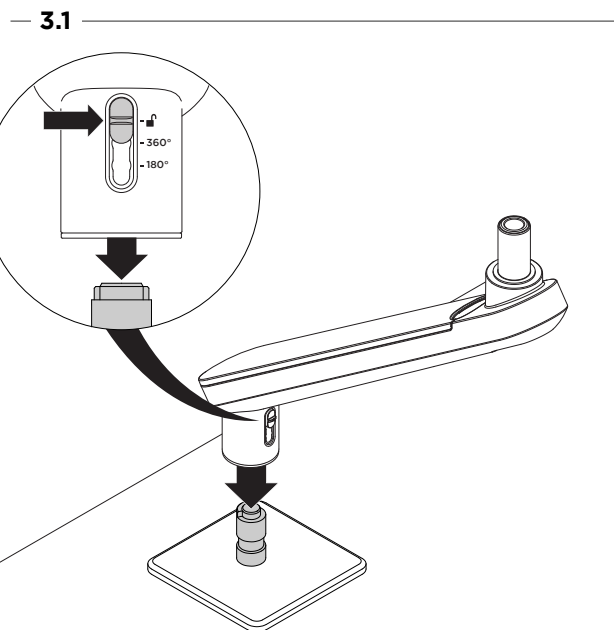

4 Attach Upper Link

4.1

IMPORTANT

Ensure plastic sleeve is fitted on lower link

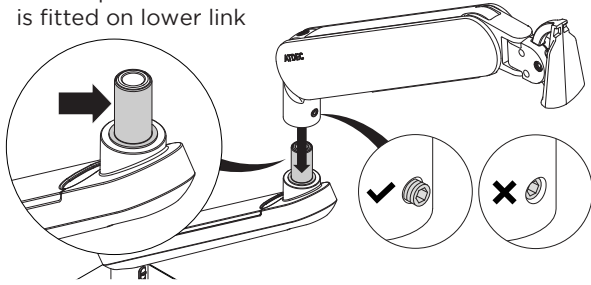

4.2

Press down firmly to ensure the upper link is fully located onto the lower link

PRESS DOWN

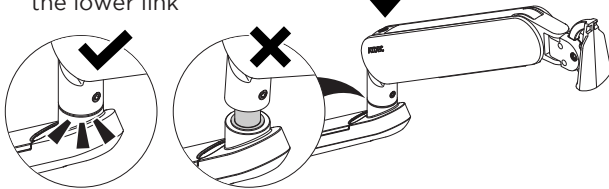

4.3

Using the 4mm hex key, tighten set screw until joint rotation is firm and smooth

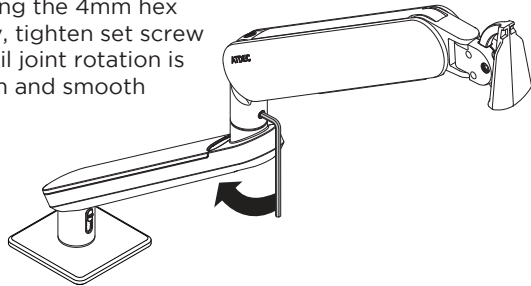

4.4

CAUTION! Check Cover Strip

To inspect cover strip, fully lower the upper link. If damaged or missing, stop installation and contact Atdec for assistance.

PUSH DOWN AND HOLD

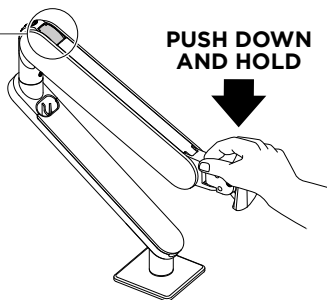

5 Mount Monitor

5.1

Check VESA mounting compatibility of monitor

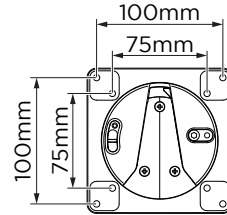

NOTE

For other sizes, use suitable adaptor plate (sold separately).

NOTE

Recessed 75x75mm VESA interfaces will require a spacer kit (sold separately)

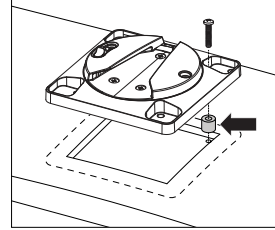

5.2

Attach VESA Plate using supplied M4x10 screws.

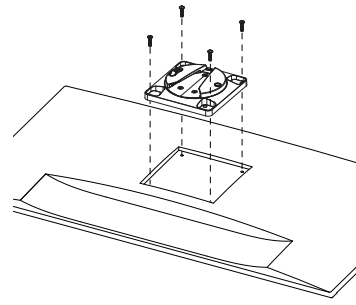

Ensure screw length suits the monitor

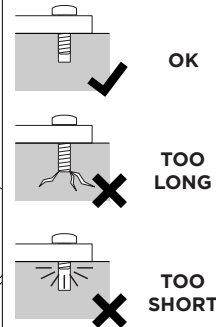

5.3

Attach monitor to arm

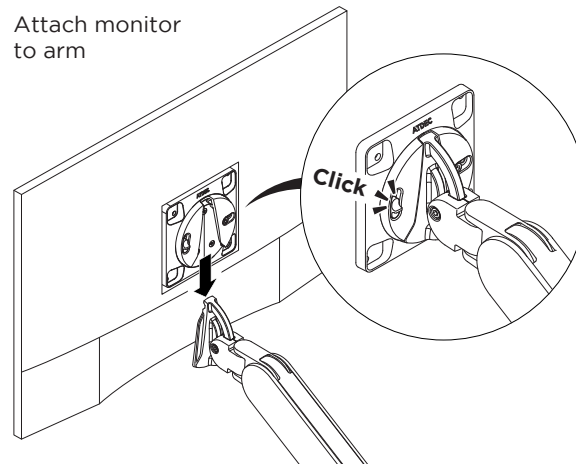

6 Adjustments

6.1 Tilt Tension

If required, adjust tilt tension using 4mm hex key. (do not over-tighten)

NOTE

Support the screen while adjusting

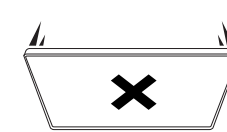
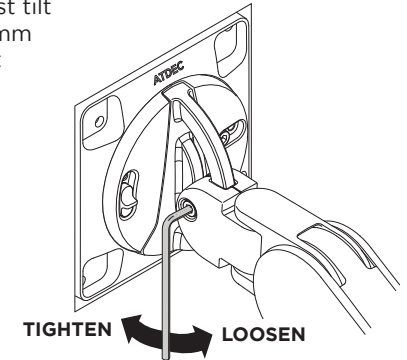

DROOPS FORWARD

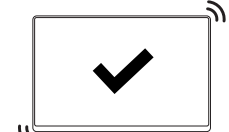

HOLDS POSITION

6.2 Monitor Rotation Tension (optional)

Adjust rotation tension using 4mm hex key.

NOTE

Adjustment may only be required for ultrawide monitors

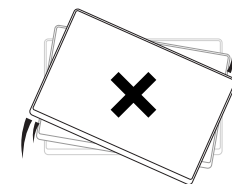
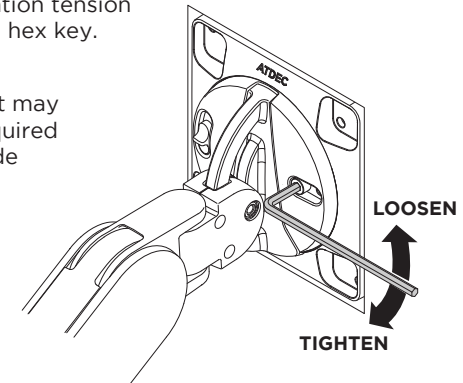

DRIFTS

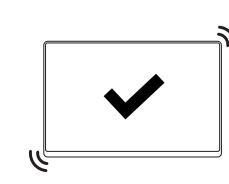

HOLDS POSITION

6.3 Counterbalance Adjustment

Using the 4mm hex key, adjust counterbalance to suit the monitor weight

TIP

For best results, adjust counterbalance with the arm and monitor in the position shown. Adjustment is easiest when the monitor is in the highest position.

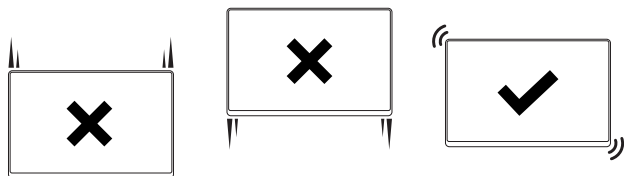
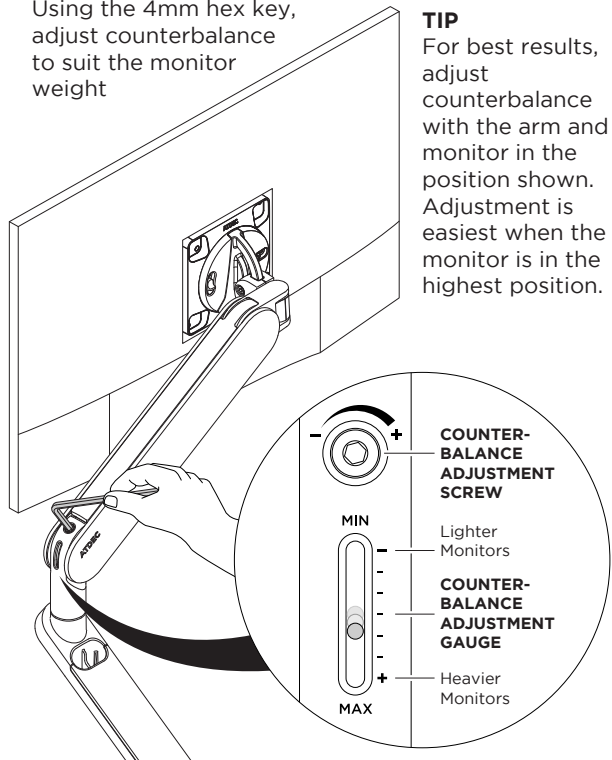

DROOPS

BOUNCES UP

HOLDS POSITION

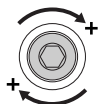

Increase tension

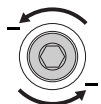

Reduce tension

TIP

When installing multiple arms with the same monitor, use the setting on the counterbalance adjustment gauge to quickly 'pre-set' other arms (fine-tuning may be required after pre-setting).

6.4 Security Screw (optional)

If desired, once monitor is attached to the arm, install the security screw. This disables the release switch, preventing theft.

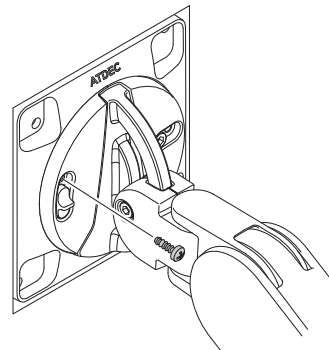

6.5 Removing Monitor

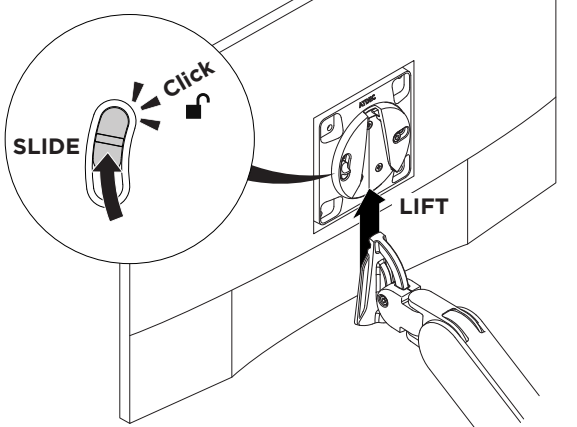

7 Cable Management

7.1 Overview

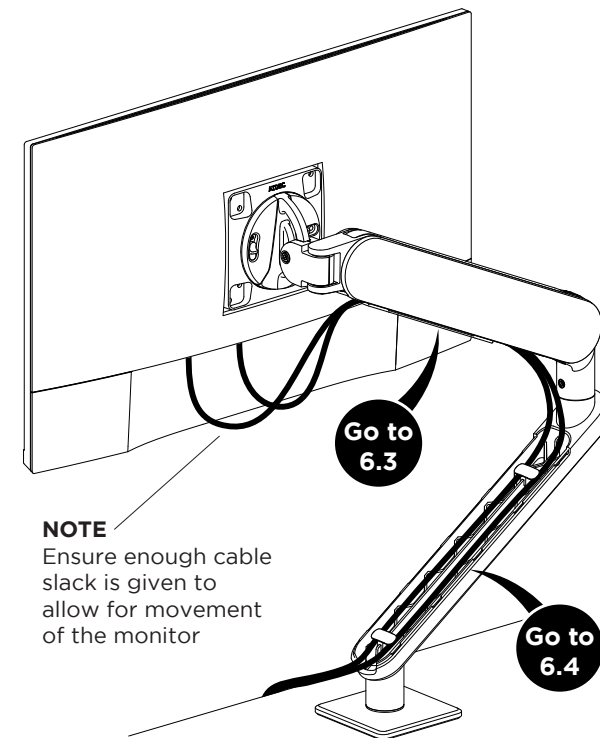

NOTE

Ensure enough cable slack is given to allow for movement of the monitor

NOTE

Allow 1.2m of cable from the work surface to the monitor. Add additional cable length to route the cable from the work surface to the computer.

7.2

If desired, store hex key in lower link

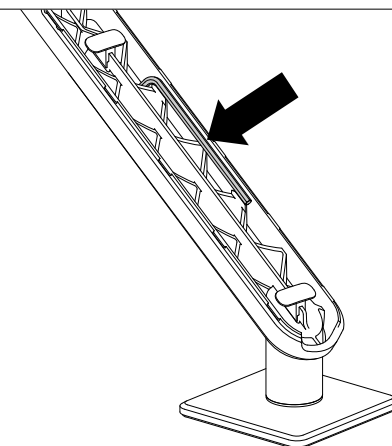

— 7.3 Route Cables Through Upper Link

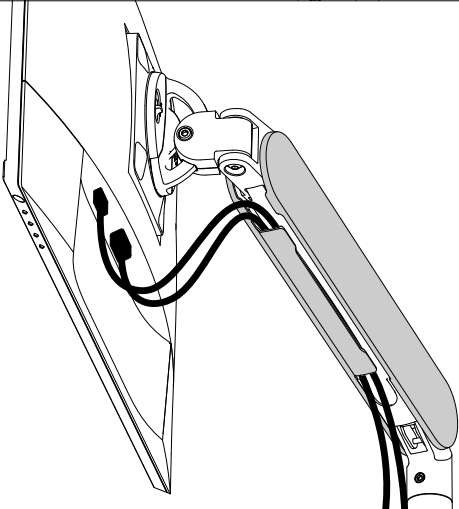
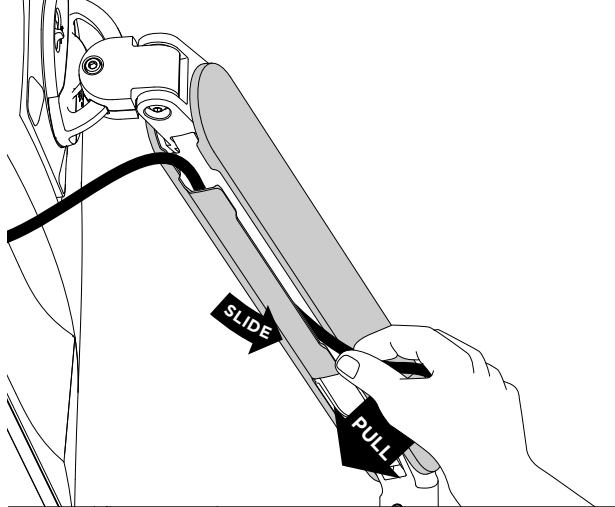
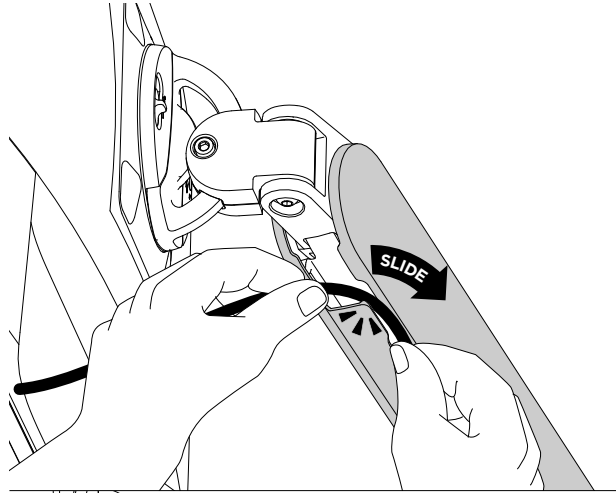

— 7.4 Remove lower link cable cover.

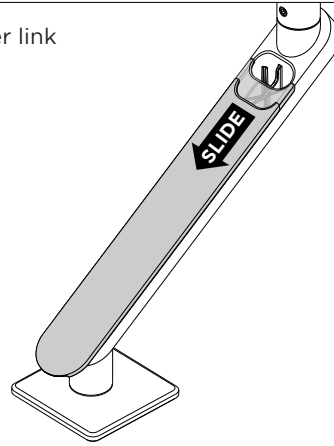

— 7.5 Tuck cables behind tabs inside lower link.

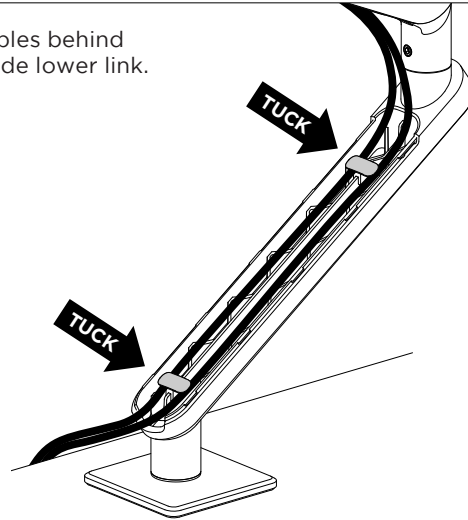

— 7.6 Re-attach lower link cable cover.

