

Dynamic Monitor Arm F clamp

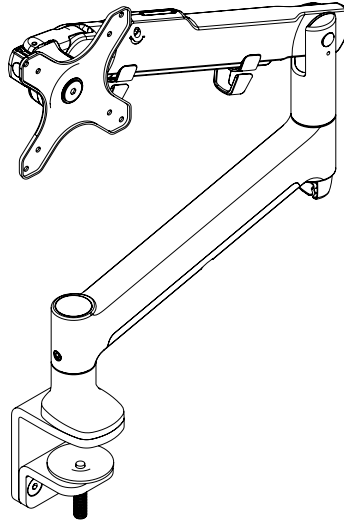

COMPONENT CHECKLIST

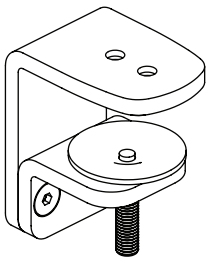

AWM-FF
F Clamp
(x1)

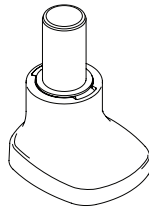

AWM-LB
Arm Base
(x1)

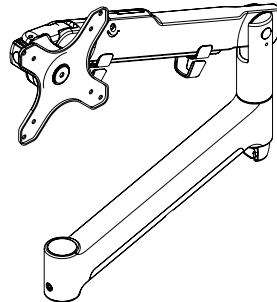

AWM-AD
Dynamic Arm
(x1)



REQUIRED TOOLS

- Phillips Head Screwdriver

CONTENTS

F Clamp

Page 2

AWM-FF

| Component Checklist + Clamp Installation

Arm Base

Page 3

AWM-LB

| Component Checklist + Base Installation

Dynamic Arm

Page 4

AWM-AD

| Component Checklist + Arm Installation

IMPORTANT INFORMATION

- ! Please ensure this product is installed as per these installation instructions.
- ! Do not remove/ throw away the plastic sleeve on arm base and arm links.
- ! The manufacturer accepts no responsibility for incorrect installation.
- ! This product is compatible with Atdec AWM Series products.
- ! Product must only be installed on a solid work surface capable of supporting the weight of all equipment being mounted.
- ! Curved monitors, deep devices (such as all-in-one PCs), VESA mounted accessories (such as mini PC brackets and mounts), and offset VESA locations exert additional leverage that can exceed the capacity of the mount even though the monitor weight may be within the stated range. Please contact Atdec if you would like further information.

COMPONENT CHECKLIST

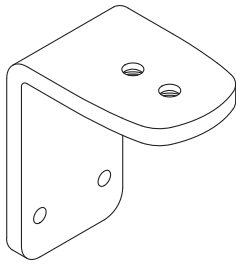

A
Upper Clamp
(x1)

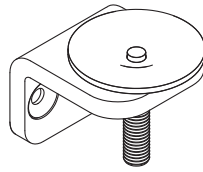

B
Lower Clamp
(x1)



C
Screw
M8 x 16mm
(x2)

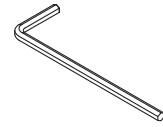

D
5mm
Hex Key
(x1)

1. Attach base to upper clamp

NOTE: Base packaged separately

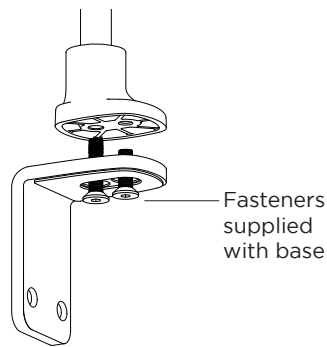

2. Attach lower clamp to upper clamp

2.1 Measure the worksurface thickness and choose the suitable lower clamp position

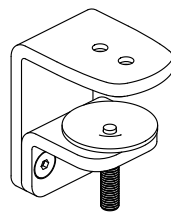
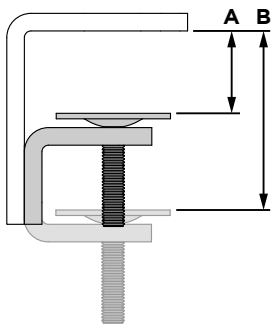

A - Normal
0 - 36mm
(0.00 - 1 3/8")

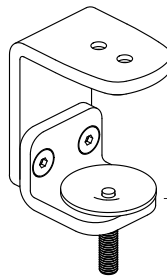

B - Inverted
36 - 79mm
(1 3/8" - 3")

2.2 If using inverted position change the screw direction of the lower clamp

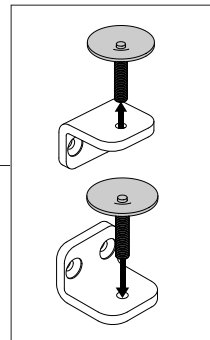

2.3 Attach lower clamp to upper clamp in the suitable position using the two provided screws. (Normal position shown here)

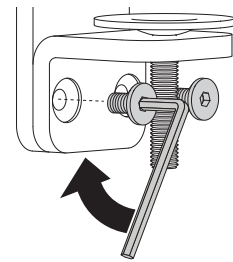

Note: If there is only a small gap behind the worksurface, perform **Step 3.1** before this step.

3. Fit fixing to work surface

3.1 Place in desired location on worksurface

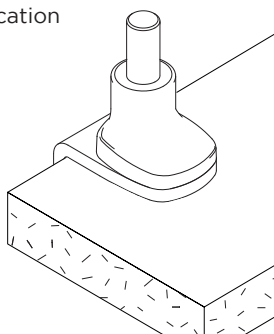

3.2 Screw in pressure plate and **tighten firmly.**

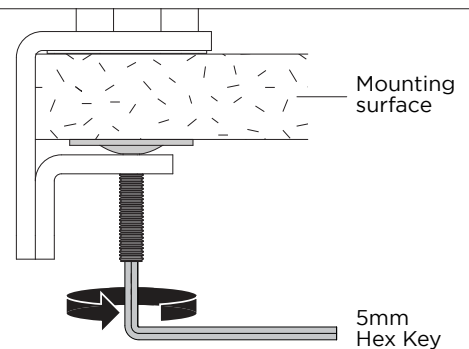

COMPONENT CHECKLIST

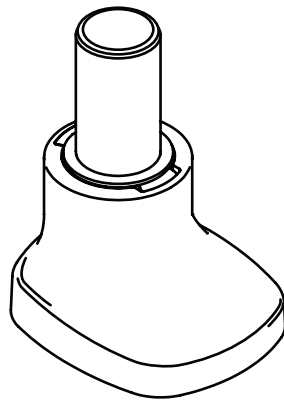

A
Base
(x1)



B
Screw
M8x16
(x1)

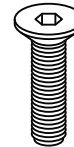

C
Screw
M8x30
(x1)

1. (Optional) Set arm rotation to 180°

Note rotation is set to 360° by default.

1.1 Remove plastic sleeve.

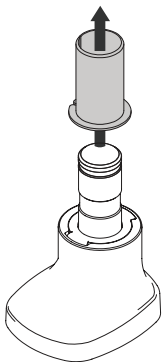

1.2 To remove rotation ring press down on front edge and lift.

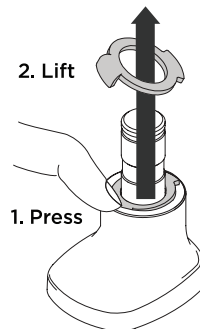

1.3 Replace rotation ring in the desired orientation and **replace** plastic sleeve.

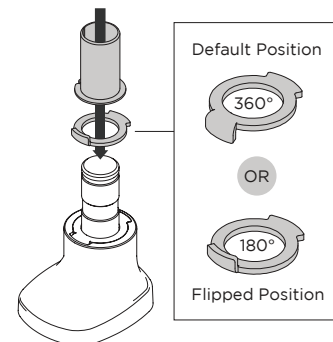

2. Fit arm onto Base

2.1 Push arm onto base, grub screw must be backed off at this time.

NOTE: Ensure plastic sleeve is on shaft before fitting arm.

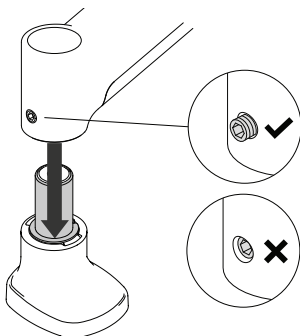

NOTE: Arm packaged separately

2.2 Ensure arm is fully pushed onto base.

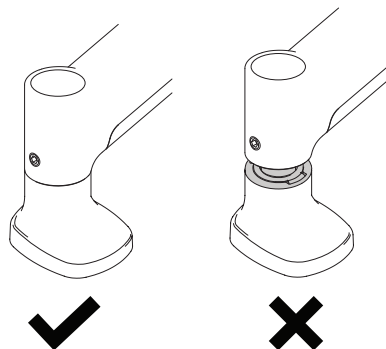

2.3 Tighten set screw.

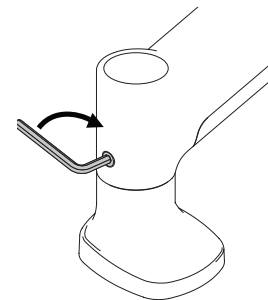

NOTE: Check the arm pan adjustment is smooth after tightening.

COMPONENT CHECKLIST					WEIGHT RANGE	
<p>A Dynamic Monitor Arm (x1)</p> <p>B VESA Head (x1)</p>	<p>C Screw M4x25mm (x4)</p>	<p>D Screw M4x16mm (x4)</p>	<p>E Screw M4x12mm (x4)</p>	<p>Flat Monitors 0 - 9kg (0 - 20lbs)</p> <p>Curved Monitors 0 - 6kg (0 - 13.5lbs)</p> <p>Monitor weight should be within the weight range of all modular elements that make up the complete monitor mounting solution.</p>		
	<p>F Spacer (x4)</p>	<p>G Security Screw (x1)</p>	<p>H 4mm Hex Key (x1)</p>			

1. Attach VESA head to monitor

<p>1.1 Check VESA mounting compatibility.</p> <p>NOTE: For other sizes, use a suitable adaptor plate (sold separately).</p>	<p>1.2 Attach VESA head onto monitor with provided screws.</p> <p>NOTE: Spacers may be required for curved, recessed or uneven monitor surfaces.</p>	<p>NOTE: Be sure to use a screw length that suits the monitor.</p> <p>✓ Flush ✓ Spacer</p> <p>✗ Too long ✗ Too short</p>
---	--	---

2. Mount monitor

<p>2.1. Insert VESA head into the monitor arm.</p> <p>Monitor arm</p>	<p>2.2. Ensure that the VESA head sits flush within the monitor arm. There should be no gap.</p> <p>Gap No gap</p>	<p>2.3. Push the lever down to secure it to the arm assembly.</p>
--	---	--

3. Adjust tilt tension & Install security screw

3.1. Use the provided Hex Key to adjust the tilt tension until the monitor holds in a vertical position at the end of the arm.

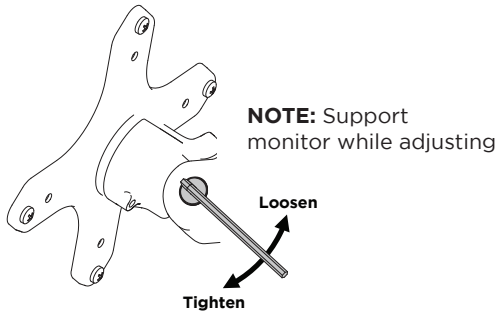

3.2. (OPTIONAL) To install the optional security screw tilt the head upwards.

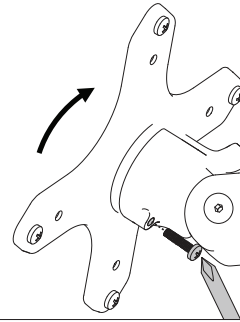

4. Adjust arm tension

4.1 To accurately set the tension of the arm, position the monitor at 90 degrees

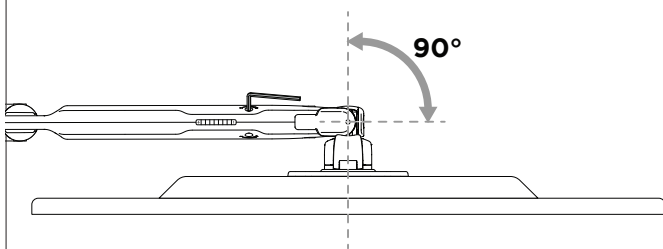

4.2 Use the allen key to adjust the arm tension to the weight of the monitor. Follow steps **6.3** to **6.5** to set the tension.

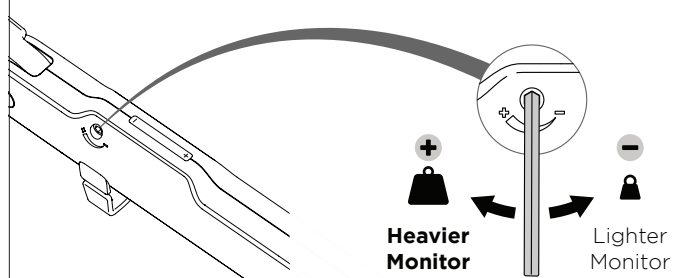

4.3 If the monitor sags or falls down, increase the arm tension by rotating the screw clockwise.

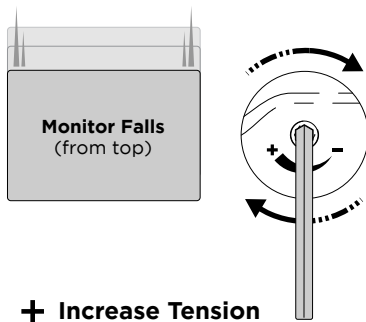

4.4 If the monitor springs upwards from the bottom position, decrease the arm tension by rotating the screw anti-clockwise.

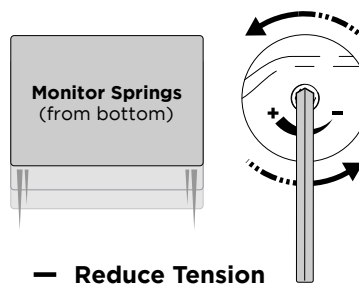

4.5 If the monitor floats or hovers in all positions the arm tension is balanced and does not require further adjustment.

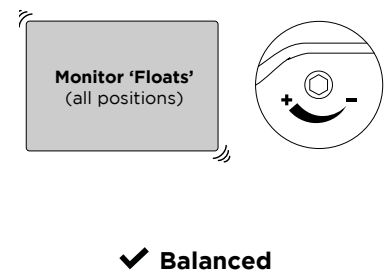

5. Tension gauge

When installing multiple monitors of a similar weight, use the tension gauge to make installation faster.

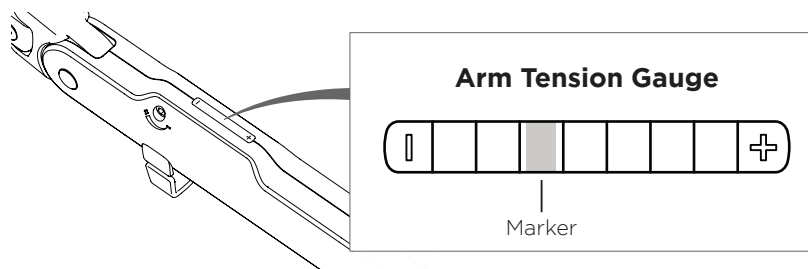

1. Set up one monitor and record the position of the marker on the gauge.
2. When installing subsequent monitors, pre-tension the arm to the recorded amount, then fine-tune the tension by following steps **4.3** to **4.5**.

6. Cable management

6.1 Plug cables into the monitor and route the cables down the arm using the cable hooks and clips.

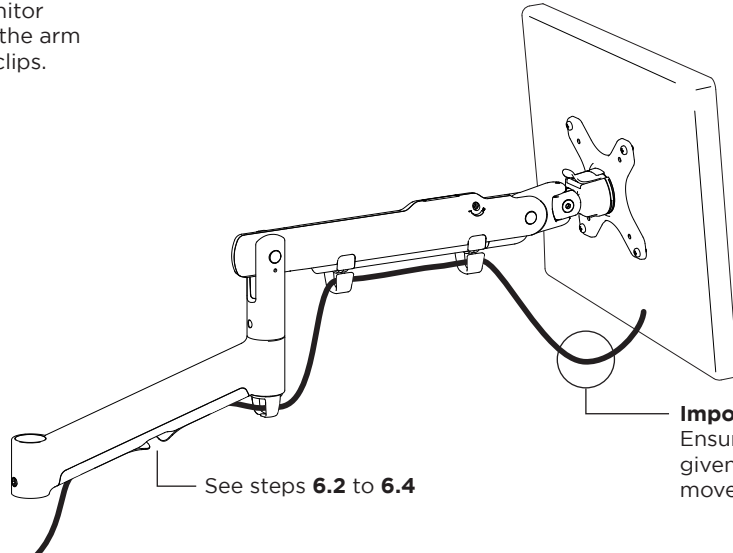

Important!

Ensure enough cable slack is given in this area to allow for movement of the monitor.

See steps **6.2** to **6.4**

6.2 Wedge cable into the central gap and slide it down the arm.

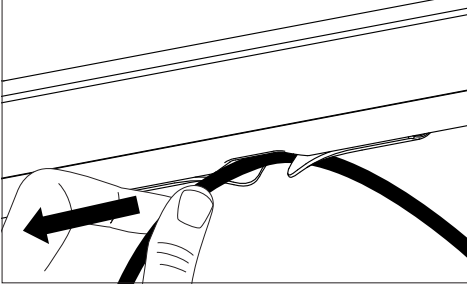

6.3 The cable should slip into the arm cavity

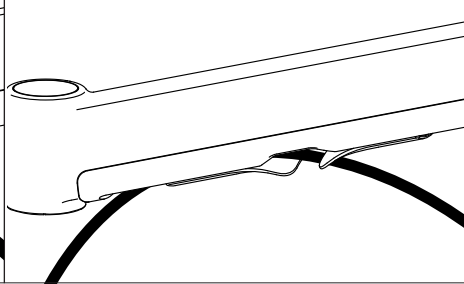

6.4 Slide the remaining loose cable from the central gap up the arm.

